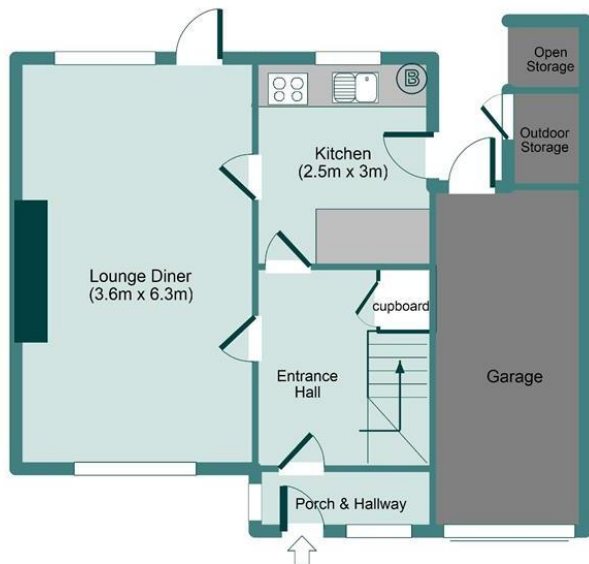

Danford Close, Oundle, Peterborough

£365,000

6 Danfords Close FP.jpg

**Ground Floor**

Floor Area: 43 sq.m / 463 sq.ft (approx)

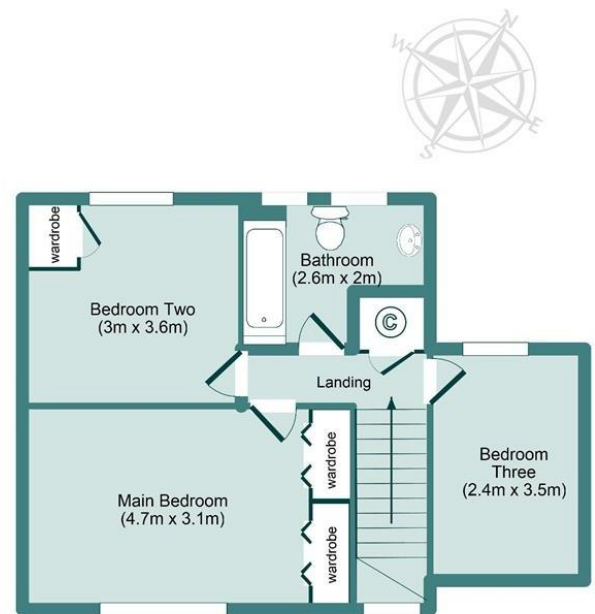
**First Floor**

Floor Area: 46 sq.m / 495 sq.ft (approx)

**Total Property Floor Area : 89 sq.m / 958 sq.ft (approx)****Inc. Garage: 104 sq.m / 1,120 sq.ft (approx)**

This plan is for illustration purposes only and may not be representative of the property. Plan not to scale.